

THE POWERPAL USER MANUAL

Instructions

The PowerPal is a revolutionary power source that can charge and provide power for many kinds of mobile electronics anywhere, anytime. It can be used at home with the included ac adapter or on the go with just the battery. In addition to the high capacity Lithium technology, the PowerPal contains numerous safety features that guard against damaging low-voltage electronics. It is also designed to provide long lasting power and includes anti-shock features. It has wide compatibility with USB and DC ports. For home users, the PowerPal makes an excellent substitute or backup power supply or ac adapter for personal electronics. For business professionals, the PowerPal is a practical alternative energy source, providing much needed extra power on the go for increased mobility. The PowerPal works as an all-in-one smart energy source with its wide variety of connector tips that allow maximum compatibility with portable electronic devices.

Before initial use please check that the product contents are complete and that you fully understand the operations of the PowerPal. Carefully read this User Manual to understand how to connect the PowerPal with your electronic devices.

The PowerPal will power most low-powered mobile devices with input voltages less than 11V using the included connector tips. These devices include:

- Mobile Phones
- PDAs/SmartPhones
- iPods – all generations
- MP3 Players
- PSP Players
- Portable DVD Players
- Portable CD Players
- Digital Cameras
- Digital Camcorders
- Handheld and portable GPS devices

THE POWERPAL (U-Series MPP-100)

Accessories list:

After opening the package you will find:

- The PowerPal
- AC Charger and USB cord to re-charge the PowerPal
- USB & DC connection tips
- Mini-USB, Sony Camera 2, and Sony DV connection tips
- iPod connection tip
- Various cellular/smart phone and PDA connection tips
- Leather bag to hold the PowerPal, charger and tips
- User guide

Product Specifications:

- Battery Type :Li-ion battery
- Input: DC-5V/1.5A
- Output: DC-5V/1.5A, 6V/1.2A, 8.4V/0.8A
- Capacity: 4400mAh, 3.7V
- Size: 3.3in H x 2.3in. L x .84in W
- Net Weight: 4.4oz.
- Recharging Time: Approx. 3 hours charging from DC, 4 hours charging from USB

Warning:

- Do not disassemble this product
- Avoid hard, physical impacts on the product
- Use the product in a dry location only
- Do not expose the product to sunlight for a long period of time
- Dispose of the product according to the applicable laws

1. Instructions Before Operating

It is important that you select the correct voltage on the PowerPal before plugging it into your device for it to charge properly. Please verify the voltage of your device by looking at the power supply that came with your device for the correct voltage. Then match this voltage with the PowerPal voltage switch at the top of the device before use.

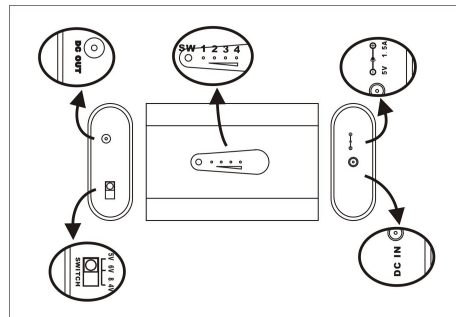

(Replace this picture with a picture of the top of the PowerPal showing the voltage switch)

Device Input voltage	The PowerPal Voltage Switch
4.0V-6.0V	5V
6.0V-7.0V	6V
7.0V-11V	8.4V

The power output will automatically shut off when an overload or a short circuit occurs. Please disconnect all devices linked to the PowerPal. The power will resume in three seconds after you reconnect the charger.

2. PowerPal Connection Instructions:

Different electronics have specific connection tips to connect them to a power source. The PowerPal comes with a variety of different tips to fit your specific digital device. Before connecting your appropriate tip, please verify that the input voltage range is correct and the tip matches the device. You may need to try different voltage ranges or choose different tips to ensure they are the correct fit.

- Mobile/Smart Phone and PDA Connection Tips

The PowerPal is equipped with a variety of the most popular mobile/smart phone and PDA connection tips. You should select the one suitable for your mobile device from the compatibility list below. If your mobile device is not listed below, you may order additional tips by visiting our website at www.premiumpowerproducts.com.

Manufacturer	Model	Tip No.
Apple	iPod: 1st/2nd gen, 3rd gen, 4th gen, nano, mini, video	02-C
Apple	Shuffle	02-D
Audiovox	Pocket PC 6600, SMT5600, VX6600	01-U1
Blackberry	6210, 6220, 6230, 6280, 6510, 7100g, 7100i, 7100r, 7100t, 7100v, 7100x, 7105t, 7130e, 7210, 7230, 7250, 7280, 7290, 7510, 7520, 8700c, 8700f, 8700g	01-U1
I-Mate	JasJAM JAMin, JasJar, K-JAM, SP5, SP5m, JAM Black, JAM, SP3i, SP3	01-U1
LG	4010, 4500, 4600, 5450, 5500, 6000, 7000, 7020, 7030, 8080, DM-100, SP-110, SP-510, V-111, TP1110, TP2110, TP5200, TP5250, LG1010, LG4NE1, LG520, LG5250, LG VS9000, KP2200, SV130, VX600, Telson 8100	01-M4
LG	AX4270, AX4750, LX225, LX325, MM535, PM325, VX3200, VX3300, VX4650, VX4700, VX5200, VX6100, VX7000, VX8000, VX8100, VX8300, VX9800m	01-M10
Motorola	RAZR V3 (all colors), SLVR L2/L6/L7, PEBL (all colors)	01-U1
Motorola	Q Phone	01-U1
Motorola	V190, V325, V330, V551, V557, V600, V60iT, V710	01-M6/01-U1
Motorola	Accompli 007, 008, 009, A338, A388, A6188, C289; 308, 2188, 3281, 6188, 7089, 8050	01-M5
Motorola	StarTAC series: 250, 260, 270C, 280, 328, L7082, L7089, P7382, P7389, P7689, P8090, P8097, P8160, P8167, P8767, P9097, V50, V100, V200, V250, V998, V2088, V2288, V3620, V3682, V3688, V3690, V8088, V8160, V8162, T250, T260, T388, T8090, T8097, T8160, T8167, T8197, T8367	01-M5
Motorola	120e, 120t, 120x, A630, A760, A768i, A840, A860, C331, C332, C333, C434c, C353, E1 ROKR, E310, E815, I60, I70, I80, I85, I90, I95, MPX200, MPX220, T72X, T73X, T120, T300P, T343, T720, T721, T722, T730, T731, V60 series, V60iT, V65P, V66, V70, V120c, V260, V262, V265, V276, V300, V330, V400, V505, V551, V557, V600, V635, V710, V810, Timeport 280	01-M6
Nokia	3155i, 6101, 6102, 6155i, 6236i, 6265i, 6282, 7370, 770, N80, N90	01-M8

Nokia	1100, 1221, 1260, 1261, 2126, 2260, 2270, 2285, 2600, 3000, 3100, 3120, 3200, 3220, 3285, 3300, 3360, 3361, 3390, 3395, 3510, 3520, 3560, 3570, 3585, 3585i, 3586i, 3587i, 3588i, 3589i, 3590, 3595, 3600, 3620, 3650, 5100, 5140, 5190, 6000, 6010, 6015i, 6016i, 6019i, 6030, 6100, 6103, 6131, 6190, 6200, 6225, 6230, 6255i, 6310i, 6340, 6340i, 6370, 6385, 6560, 6585, 6590, 6590i, 6600, 6610i, 6620, 6651, 6682, 6800, 6820, 6820i, 6822, 7210, 7250, 7250i, 7280, 7610, 7610i, 8260, 8265, 8265i, 8270, 8290, 8390, 8801, 9290, NP-GagcOD	01-H
O2	XDA Trion, XDA Neo, XDA Exec, XDA mini S, XDA Orion, XDA II mini, XDA Iis, Xphone II	01-U1
Orange	SPV M2000, SPV C500	01-U1
Palm	Treo 650, 700p, 700w	01-P1
Q-Tek	8010, 8020, 8300, 8310, 9000, 9090, 9100, 9600, S200, S110, S100	01-U1
Samsung	A560, A580, A630, A790, A795, A800, A840, A850, A900, A920, A930, A940, A950, A960, A970, D347, D407, D807, N200, N400, N625, T209, T309, T319, T609, V200, V205, V206, X495, X496, X497, X507, ZX10	01-M9
Samsung	3500, 6100, 8500, SA288, C207, D307, D357, D415, D418, D508, D608, E315, E316, E317, N625, E635, P207, Q105, R225M, S30X, S307, S308, V20X, V206, X426, X427, X427M, X497, SCH-A220, SCH-A980, SCH-C207, SCH-N105, SCH-N330, SCH-N370, SGH-C225, SGH-D410, SGH-D415, SGH-D807, SGH-E105, SGH-E207, SGH-E315, SGH-E316, SGH-E317, SGH-E335, SGH-E365, SGH-E715, SGH-N625, SGH-P107, SGH-P207, SGH-S300, SGH-R225, SGH-R225M, SGH-S307, SGH-T509, SGH-T809, SGH-V200, SGH-V205, SGH-V206, SGH-X105, SGH-X426, SGH-X427, SGH-X475, SGH-X495, SGH-X497, SGH-X667, SPH-A900	01-M1
Siemens	A55, A56, A60, A65, C55, C56, CT56, C60, C61, C62, CF62T, CF63, CT66, C70, C71, M55, M56, M65, MC60, SL55, S55, SL56, S65, S66, SX1	01-M2
Sony Ericsson	W600i, W810	01-M7
Sony Ericsson	A2218, A2288, K500i, K700, K700i, P800, P900, P910a, R300, R300D, R300IX, R300Z, R320, R320SC, R380, R520M, S700i, S710A, T20, T28, T29, T39, T39D, T2XX, T3XX, T60, T60X, T61, T61X, T62, T62U, T66, T68, T68i, T200, T226, T237, T300, T306, T316, T6XX, T608, T610, T616, T628, T610, T630, T637, Z200, Z500, Z500A, Z600	01-M3
T-Mobile	Sidekick II, Sidekick III, MDA Compact II, MDA Compact, MDA IV, MDA III	01-U1

- Other Digital Device Connection Tips

In addition to mobile/smart phones and PDAs, the PowerPal will charge many other low powered digital and mobile devices. Following is a tip guide for the other mobile devices powered by the PowerPal:

Manufacturer	Model	Tip No.
Sony	Various Digital Cameras	04-F/01-U1
Sony	Various Camcorders	barrel connectors
Various	Bluetooth Headsets	01-U1
Various	Digital Cameras	barrel connectors
Various	Camcorders	barrel connectors
Various	PSP Player	barrel connectors

Various	Portable GPS	barrel connectors
Various	Portable CD Players	barrel connectors
Various	Portable DVD Players	barrel connectors
Various	MP3 Players (not ipod)	02-D

Barrel Connector Dimensions:

04-A: 2.35mm*0.7mm

04-B: 3.0mm*1.1mm

04-C: 3.5mm*1.35mm

04-D: 4.0mm*1.7mm

04-E: 4.75mm*1.7mm

Connecting to Mobile Phones

- Check the output voltage of original charger and select the suitable tip and voltage switch
- Different plugs suit for different mobile phone, select the correct one to charge and provide power to your devices

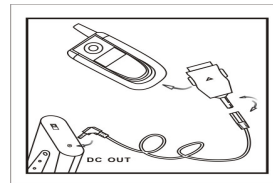

Connecting to Digital Camera/Camcorder

- Select suitable connection plug
- Check the output voltage of original charger and select the suitable connector, suitable switch

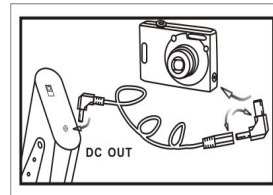

Connecting to Sony PSP

- Select barrel connection plug 04-D: 4.0mm*1.7mm
- Select 5V voltage switch, then plug the connector into Sony PSP DC port

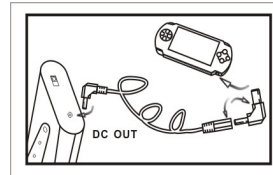

3. PowerPal Charging Instructions

The PowerPal is equipped with an AC charger and USB cable which can be used to charge the PowerPal. Charge the PowerPal using the “DC In” port located at the bottom of the PowerPal. The PowerPal begins charging with the No. 4 light indicating red. Charging will stop automatically with green indicator lights when fully charged.

- Charging with AC Adapter:
- Charging with USB Cord and USB port:
Select the USB connection cord and DC connection tip (04-E); charge The PowerPal through the computer USB port

